

PLANETARY GEAR

- REDUCTORES PLANETARIOS: combinables con la serie 168. Ver sección especial en catálogo.
- PLANETARY GEARS: combinable with 168 series. See special section in catalogue.
- REDUCTEURS PLANÉTAIRES: combinables avec la série 168. Consultez section spécial du catalogue.
- PLANETENGETRIEBE: Mit der Reihe 168 kombinierbar. Sehen Sie Sonderabschnitt im Katalog.

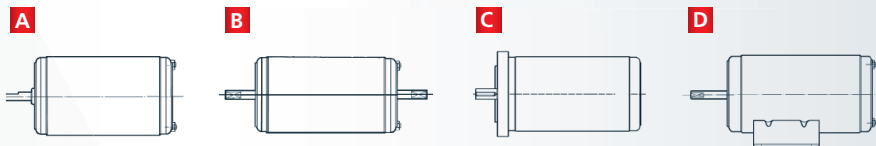

REFERENCIA REFERENCE REFERENZNUMMERN	TENSIÓN NOMINAL NOMINAL VOLTAGE TENSION NOMINALE NENNSPANNUNG	PAR NOMINAL NOMINAL TORQUE COUPLE NOMINAL DREHMOMENT NOMINAL	VELOCIDAD NOMINAL NOMINAL SPEED VITESSE NOMINALE GESCHWINDIGKEIT NOMINAL	CORRIENTE NOMINAL NOMINAL CURRENT COURANT NOMINAL NOMINALSTROM	PAR DE ARRANQUE STARTING TORQUE COUPLE DE DÉMARRAGE ANZUGSDREHMOMENT	CORRIENTE DE ARRANQUE STARTING CURRENT COURANT DE DÉMARRAGE ANLAUFSTROM	EJE SHAFT ARBRE WELLE	CONEXIONES CONNECTIONS CONNEXIONS ANSCHLUSSTART	ESQUEMA ELÉCTRICO WIRING DIAGRAM SCHEMA ELECTRIQUE SCHALTBILD	PESO APROXIMADO APPROXIMATE WEIGHT POIDS APPROXIMATIF GEWICHT (ca)	GRADO DE ESTANQUEIDAD WATER TIGHTNESS ÉTANCHÉITÉ FEUCHTIGKEITSSCHUTZKLASSE	DISEÑO: A-B DESIGN: A-B DESSIN: A-B ABBILDUNG: A-B	CURVA CURVE COURBE KURVE
	Un (V)	Mn (N.m./lb.ft.in)	Pn (r.p.m.)	In (A)	Ma (N.m./lb.ft.in)	Ia (A)				P (kg/lb.t)	IP		
168.4105.20.04	12	0.50 / 4.42	1900	14	3.0 / 26.5	64	E8	C8	EE1	2.6 / 6.9	IP40	A	37
168.4105.30.04	24	0.50 / 4.42	1900	7	3.0 / 26.5	32	E8	C8	EE1	2.6 / 6.9	IP40	A	37
168.4108.20.04	12	0.45 / 3.98	2800	19	3.0 / 26.5	100	E9	C9	EE4	2.6 / 6.9	IP40	A	39
168.4108.30.04	24	0.45 / 3.98	2800	10	3.0 / 26.5	52	E9	C9	EE4	2.6 / 6.9	IP40	A	39
168.4111.20.04	12	0.75 / 6.64	1000	11	2.8 / 24.8	36	E11	C9	EE2	2.6 / 6.9	IP40	A	40
168.4111.30.04	24	0.75 / 6.64	1000	5.5	2.8 / 24.8	18	E11	C9	EE2	2.6 / 6.9	IP40	A	40
168.4112.20.04	12	0.70 / 6.19	1500	14	3.0 / 26.5	56	E12	C11	EE2	2.6 / 6.9	IP40	A	42
168.4112.30.04	24	0.70 / 6.19	1500	7	3.0 / 26.5	28	E12	C11	EE2	2.6 / 6.9	IP40	A	42
168.4115.30.04	24	0.50 / 4.42	3000	11	3.0 / 26.5	70	E13/E41	C13	EE2	2.6 / 6.9	IP40	A	41
168.4116.20.04	12	0.50 / 4.42	1900	14	3.0 / 26.5	64	E8	C8	EE1	2.6 / 6.9	IP40	D	37
168.4116.30.04	24	0.50 / 4.42	1900	7	3.0 / 26.5	32	E8	C8	EE1	2.6 / 6.9	IP40	D	37
168.4121.30.04E	24	0.50 / 4.42	3000	11	3.0 / 26.5	70	E11/E11	C13	F2	2.6 / 6.9	IP40	B	41
168.4122.30.04	24	0.75 / 6.64	1000	5.5	2.8 / 24.8	18	E13/E41	C13	EE2	2.6 / 6.9	IP40	A	40
168.4123.20.04	12	0.50 / 4.42	2100	16	3.0 / 26.5	76	E13/E41	C13	EE2	2.6 / 6.9	IP40	A	43
168.4123.30.04	24	0.50 / 4.42	2100	8	3.0 / 26.5	38	E13/E41	C13	EE2	2.6 / 6.9	IP40	A	43
168.4134.30.04	24	0.30 / 2.65	750	1.5	1.5 / 13.3	7	E59	C9	EE2	2.6 / 6.9	IP40	A	44
168.4136.30.00E	24	0.75 / 6.64	1000	5.5	2.8 / 24.8	18	E63	C42	F2	2.6 / 6.9	IP40	C	40

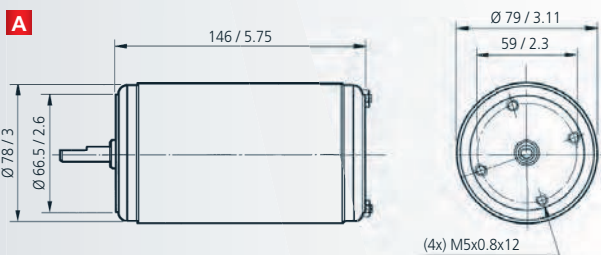

C Flange according to IEC 63 B14 - Puntos de anclaje según IEC 63 B14

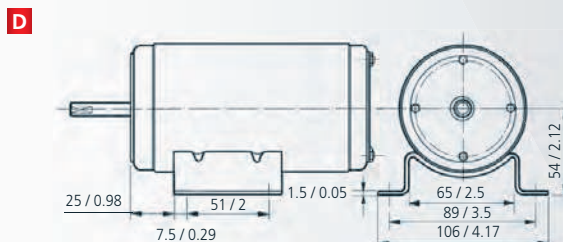
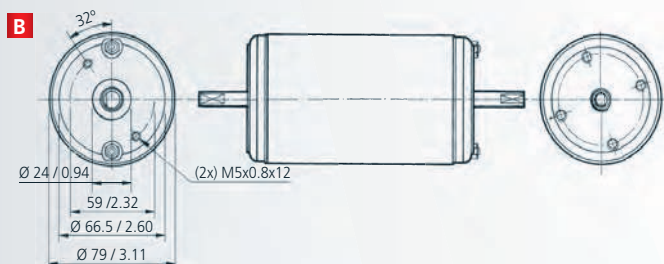
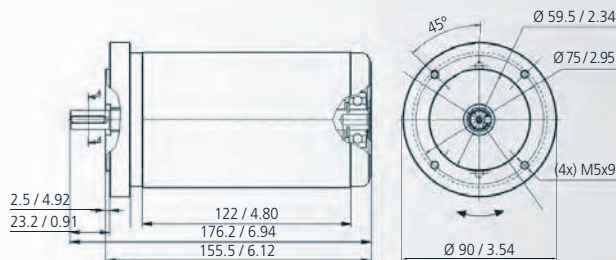

mm / inch

EJE SHAFT ARBRE WELLE

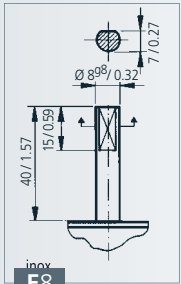

E8

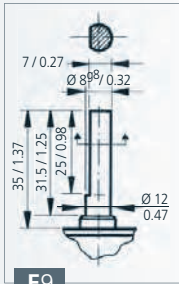

E9

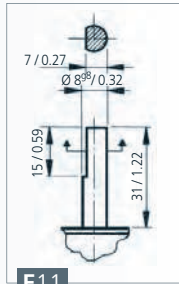

E11

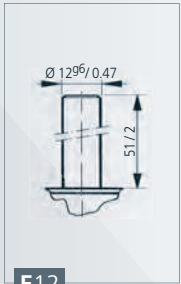

E12

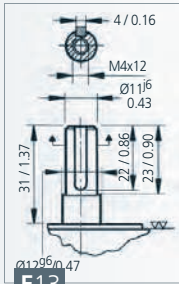

E13

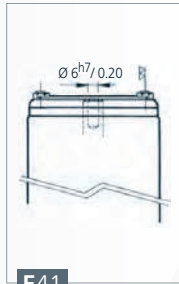

E41

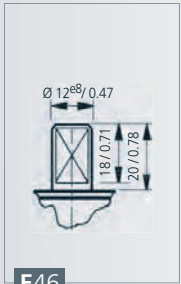

E46

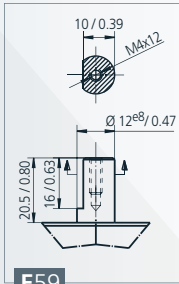

E59

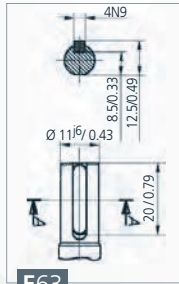

E63

ESQUEMA ELÉCTRICO WIRING DIAGRAM
SCHÉMA ÉLECTRIQUE SCHALTBILD

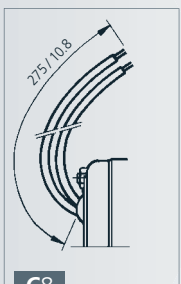

C8

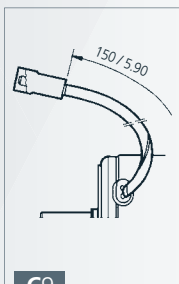

C9

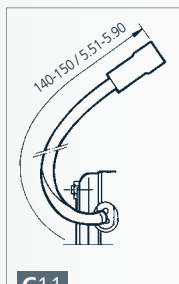

C11

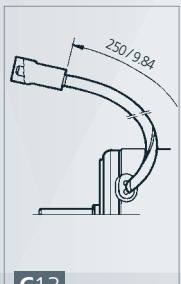

C13

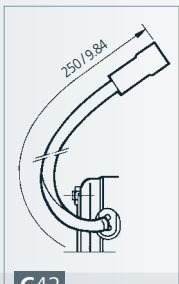

C42

CONEXIONES CONNECTIONS CONNEXIONS ANSCHLUSSART

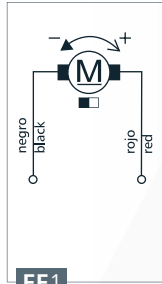

EE1

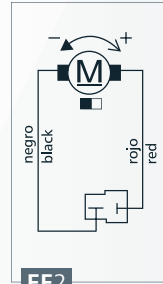

EE2

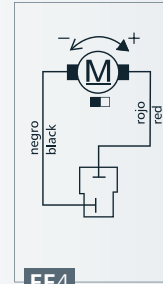

EE4

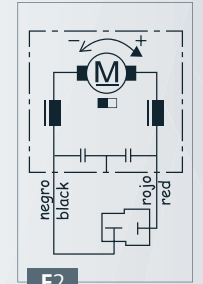

F2

CURVAS CURVES COURBES KURVEN

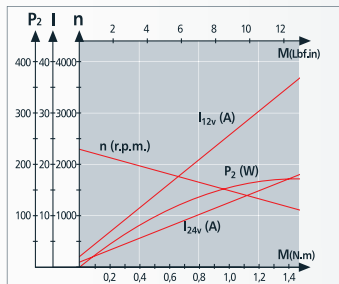

37

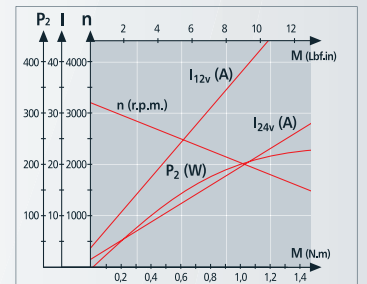

39

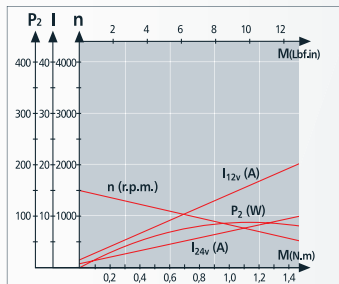

40

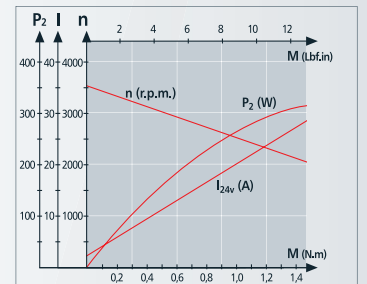

41

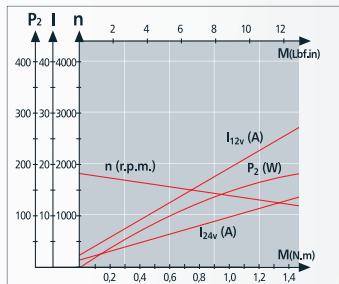

42

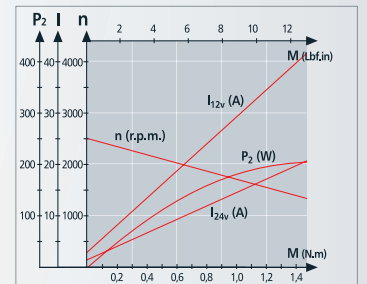

43

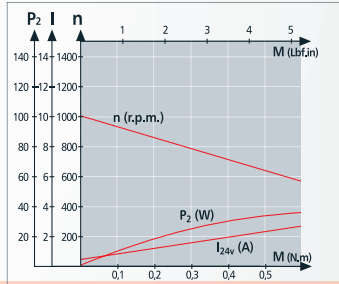

44