

PLANETARY GEAR

- REDUCTORES PLANETARIOS: combinables con la serie 169. Ver sección especial en catálogo.
- PLANETARY GEARS: combinable with 169 series. See special section in catalogue.
- REDUCTEURS PLANETAIRES: combinables avec la série 169. Consultez section spécial du catalogue.
- PLANETENGETRIEBE: Mit der Reihe 169 kombinierbar. Sehen Sie Sonderabschnitt im Katalog.

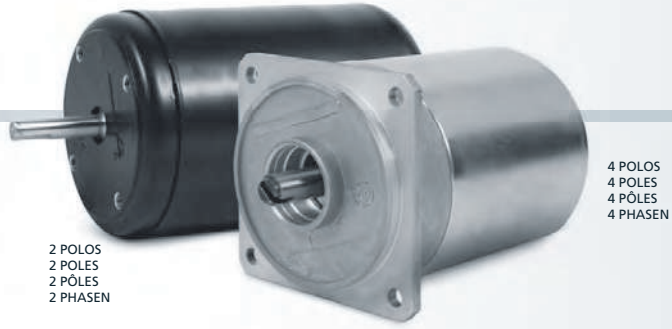

2 POLOS
2 POLES
2 PÖLES
2 PHASEN

4 POLOS
4 POLES
4 PÖLES
4 PHASEN

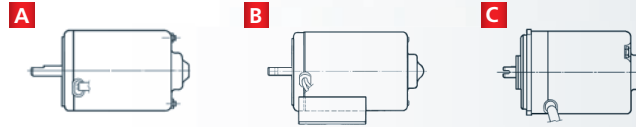

REFERENCIA REFERENCE NUMBER REFERENZNUMMERN	TENSION NOMINAL NOMINAL VOLTAGE TENSION NOMINALE NENNSPANNUNG	PAR NOMINAL NOMINAL TORQUE COUPLE NOMINAL DREHMOMENT NOMINAL	VELOCIDAD NOMINAL NOMINAL SPEED VITESSE NOMINALE GESCHWINDIGKEIT NOMINAL	CORRIENTE NOMINAL NOMINAL CURRENT COURANT NOMINAL NOMINALSTROM	PAR DE ARRANQUE STARTING TORQUE COUPLE DE DÉMARRAGE ANZUGSDREHMOMENT	CORRIENTE DE ARRANQUE STARTING CURRENT COURANT DE DÉMARRAGE ANLAUFSTROM	EJE SHAFT ARBRE WELLE	CONEXIONES CONNECTIONS CONNEXIONS ANSCHLUSSART	ESQUEMA ELÉCTRICO WIRING DIAGRAM SCHEMA ÉLECTRIQUE SCHALTBILD	PESO APROXIMADO APPROXIMATE WEIGHT POIDS APPROXIMATIF GEWICHT (ca.)	GRADO DE ESTANQUEIDAD WATERTIGHTNESS ÉTANCHÉITÉ FEUCHTIGKEITSSCHUTZKLASSE	DISEÑO: A,B DESIGN: A,B DESSIN: A,B ABBILDUNG: A,B	CURVA CURVE COURBE KURVE
	Un (V)	Mn (N.m./lbf.in)	n _n (r.p.m.)	I _n (A)	Ma (N.m./lbf.in)	I _a (A)				P (kg/lb.t)	IP		
169.4106.20.04	12	0.40 / 3.54	1900	11	2.0 / 17.7	46	E14	C14	EE2	2.0 / 5.35	IP53	A	45
169.4106.30.04	24	0.40 / 3.54	1900	5.5	2.0 / 17.7	23	E14	C14	EE2	2.0 / 5.35	IP53	A	45
169.4107.20.04	12	0.40 / 3.54	2900	16	2.2 / 19.4	100	E15	C15	EE2	2.0 / 5.35	IP53	A	46
169.4107.30.04	24	0.40 / 3.54	2900	8	2.2 / 19.4	50	E15	C15	EE2	2.0 / 5.35	IP53	A	46
169.4110.20.04	12	0.40 / 3.54	1500	9	2.0 / 17.7	38	E16	C16	EE6	2.0 / 5.35	IP53	A	47
169.4110.30.04	24	0.40 / 3.54	1500	4.5	2.0 / 17.7	19	E16	C16	EE6	2.0 / 5.35	IP53	A	47
169.4113.20.09	12	0.40 / 3.54	3200	16	2.2 / 19.4	85	E18	C18	EE8	1.37 / 3.67	IP53	C	48
169.4113.30.09	24	0.40 / 3.54	3200	8	2.2 / 19.4	43	E18	C18	EE8	1.37 / 3.67	IP53	C	48
169.4122.20.09	12	0.30 / 2.65	4600	16	1.8 / 15.9	100	E18	C18	EE8	1.37 / 3.67	IP53	C	49
169.4124.20.04	12	0.40 / 3.54	1900	11	2.0 / 17.7	46	E60	C14	EE2	2.0 / 5.35	IP53	B	45
169.4124.30.04	24	0.40 / 3.54	1900	5.5	2.0 / 17.7	23	E60	C14	EE2	2.0 / 5.35	IP53	B	45
169.4128.20.04	12	0.40 / 3.54	1500	9	2.0 / 17.7	38	E64	C26	EE1	2.0 / 5.35	IP53	B	47

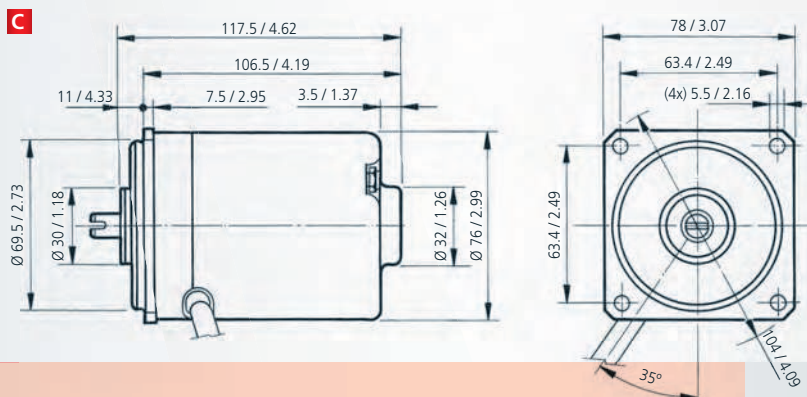
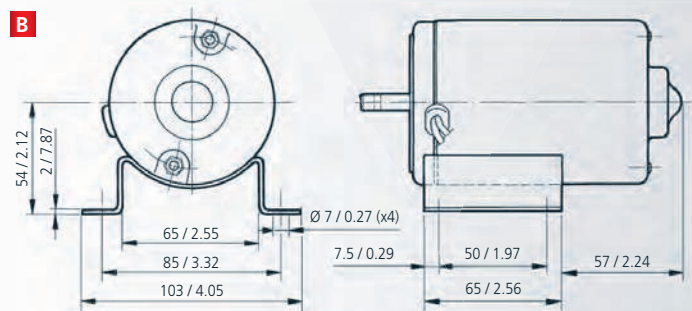
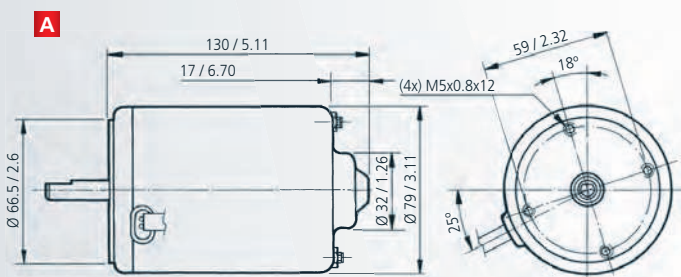

mm / inch

EJE SHAFT ARBRE WELLE

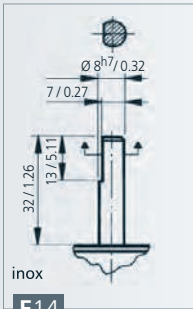

E14

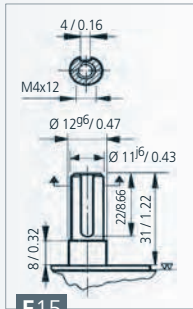

E15

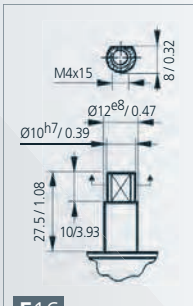

E16

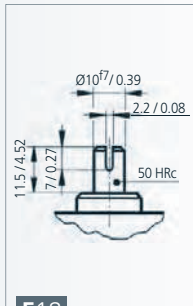

E18

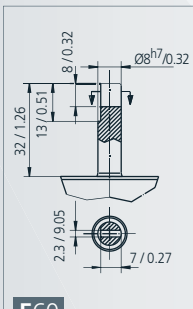

E60

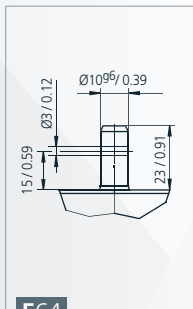

E64

ESQUEMA ELÉCTRICO WIRING DIAGRAM
SCHEMA ÉLECTRIQUE SCHALTBIELD

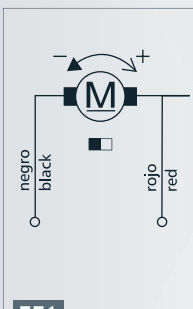

EE1

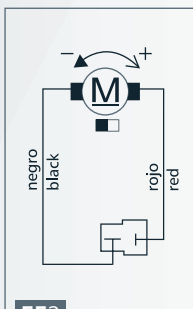

EE2

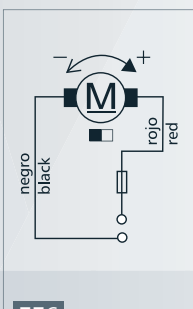

EE6

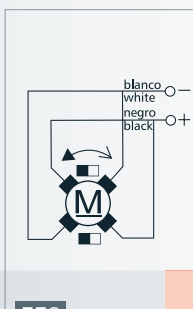

EE8

CONEXIONES CONNECTIONS
CONNEXIONS ANSCHLUSSART

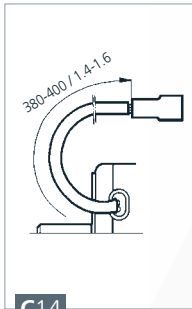

C14

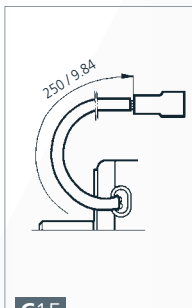

C15

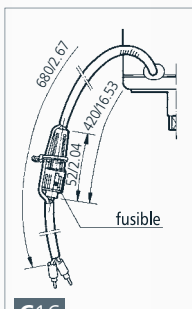

C16

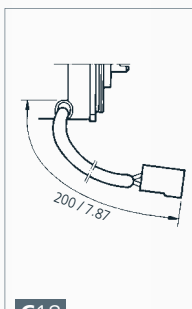

C18

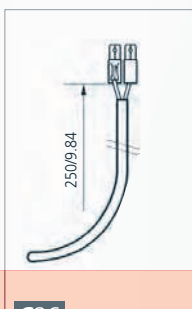

C26

CURVAS CURVES COURBES KURVEN

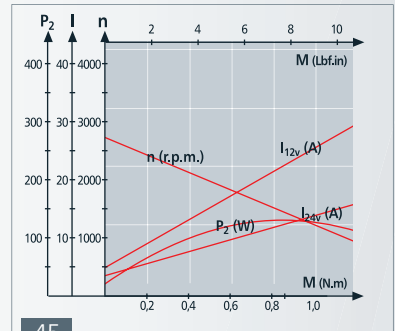

45

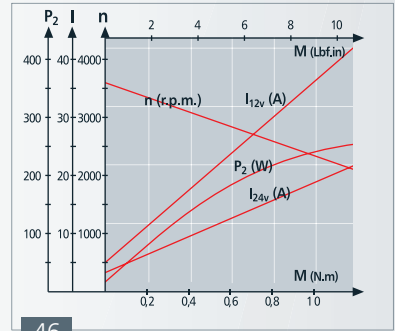

46

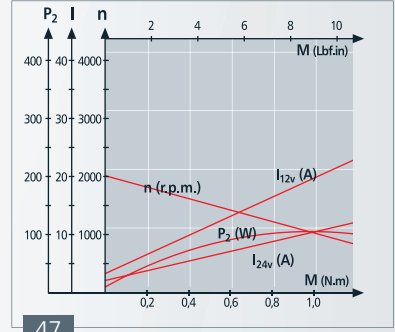

47

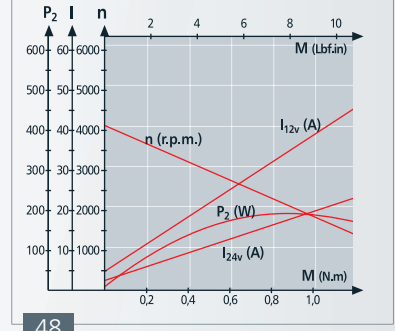

48

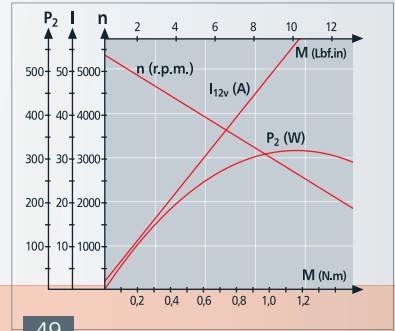

49